



Waldhäusl
Appartement
Neukirchen

Some more detailed information

Please contact the reception of "Naturdorf Oberkühnreit" 2-3 days before your arrival date to confirm your check in time and the amount of traveling people. They will keep your key for you. In case of diversify check-in, please inform us, so we can wait for you, or transmit you your key code.

Adress and contact:

Naturdorf Oberkühnreit
Marktberg 143
5741 Neukirchen am Großvenediger
Österreich

GPS coordinates:

N47° 15' 19,01"
E12° 16' 01,26"

Reception Natordorf Oberkühnreit:
Mrs. Steixner (Naturdorf mobil):
Mr. Stratoff (Waldhäusl mobil):

(+43) 6565 214 43
(+43) 664 104 56 15
(+43) 650 637 93 05

The Waldhäusl

Arrival and departure

arrival after 2 pm
departure before 10 am

Key safe

The key code that you receive from us (see the envelope in your welcome basket), applies to the respective duration of your stay. The key safe is located behind the house at the stairway. Enter the four-digit code on the keypad and press enter (E). You can also keep your key there while you're skiing...

Heating

The Waldhäusl is heated by a fully automatic pellet boiler, which also prepares the warm water. You can adjust the room temperature on the thermostat-modulators on the radiators.

Water

Our water has drinking water quality (hot and cold).

Smoking

We beg all smokers to smoke on our terraces. Ashtrays are provided on the window sills.

Kitchen

The kitchens in the appartements are fully equipped. At the bottom of the oven is a protective film (no wax paper!). Please leave it in the oven. Under the sink you find soap and sponges. All kitchens are equipped with a blender, a kettle, a toaster and a coffee machine.

Skis and ski boots

Please let your skis outside the apartment and use the ski rack in the entrance area of your apartment, or under the staircase instead. Your vestibule has underfloor heating, please let your ski boots there to dry. We kindly beg you not to walk around with ski boots in the rooms.

Sliding doors and front doors

Please make sure that the doors are always closed completely, otherwise ice might arise, which prevent a proper opening and closing.

Please make yourself familiar with the locking mechanism of our sliding doors:

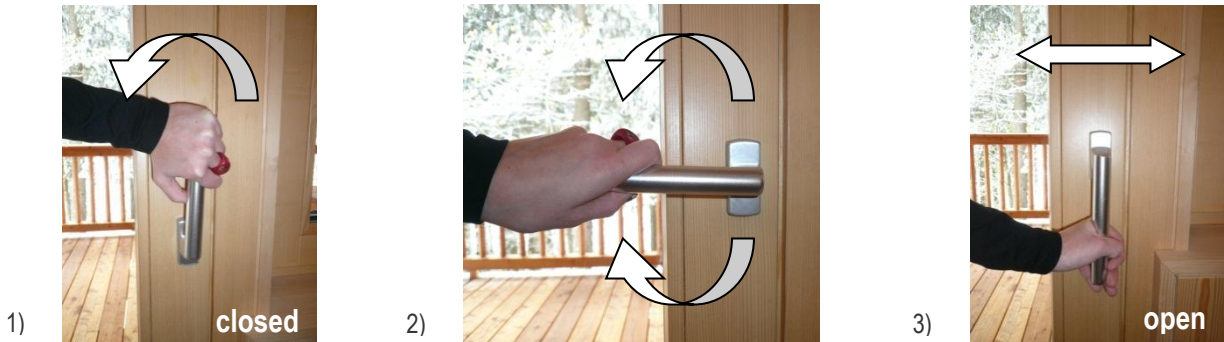

Shutters

All rooms have electric shutters. The controls are located near the doors - over or under the light switches. ▲ open ▼ close

Waste separation

Please separate the garbage properly. The garbage fee only covers the basic costs.

Internet/ wireless LAN

To log into the system, type "Internet" as the password.

Sauna (three times per week including Sun, Tue, Thu)

The sauna is located in the "Naturdorf Oberkühnreit" and may be used by you to order. Please bring sauna towels.

Art and Gallery

You can buy all paintings hanging out in the Waldhäusl. If you are interested in any of them we will be encouraged to help you.

Plants

Please do not water our potted plants.

Driving directions



If your GPS advise you the route over the Gerlos Pass, please choose an alternative (eg, via Kitzbühel and the pass-turn road, or else via Saalfelden). This will save you time and hassle usually.

1. Coming from Mittersill you are on **B165 in direction to Gerlos**.
2. Stay on **B165 till approximately 700 m after Neukirchen**.
3. Turn right at the sign "**Rosberg**" (Panoramaweg, big blue ball) and follow the road.
4. At the end of the line (at the Kreuzhäusl) you **follow the road uphill**.

For reception

5. After a long right curve you control directly toward the entrance of the "Naturdorf Oberkühnreit", where your key is already waiting for you.

For Waldhäusl

5. After about 70 m you can see a house on your right side. A few meters behind this house you can see the Waldhäusl. Turn right and enter the accessibility.
6. Just drive up to the Waldhäusl.
7. Enjoy your stay.

Thank you for your booking and see you soon in Waldhäusl.
The Haven in the trees...